



HD ULTRA MFP



SD4400 MFP



XD2400 MFP



SD3600 MFP



## Add a Contex scanner to any printer for a powerful, versatile, high quality MFP solution

Multi-function printers (MFPs) are compact and convenient, but often limited in features and capabilities. A Contex MFP solution lets you add a Contex scanner to any wide-format printer for an MFP with more powerful features, better image quality and unmatched versatility.

# The smart way to MFP convenience

If your business is like most, you're probably being asked to hold back on new equipment purchases and squeeze more value out of what you already own. That's why built-in MFPs are not always the smartest choice today. These units are costly, and they often come with limited features, quality and flexibility. And when you buy one, you're also paying for expensive printer functionality you might already own.

An MFP solution from Contex can turn any new or existing printer into a copier, giving you the small footprint you need without compromising on performance and versatility. We've got an MFP solution for any environment—from occasional walk-up copying, printing and scanning in the office, to high-volume operator-driven services in reprographics departments, copy shops and printing and scanning service centers.

## Big performance, small footprint

A Contex MFP solution gives you intuitive, powerful walk-up scanning and copying without taking up any more floor space than your existing printer. You get outstanding image quality, with real-time view of enhancements and automatic cleanup of faded, dirty, or poorly shaded documents.

## Easy to use for any office worker

An intuitive touch-screen interface, auto-naming templates and convenient presets make our MFP solutions easy to use, with no special training needed. And built-in workgroup collaboration capabilities mean anyone can scan to email, scan to folder, and share the scanner with others on your LAN.

## Productivity powerhouse

With simultaneous printing/copying while scanning, batch scanning, high scanning speeds, distributed copying and scanning to multiple printers, your Contex MFP solution will accelerate your processes. It will also help you streamline workflows with one-touch buttons and sharing over the network. For improved flexibility, you can exchange printers, work with different file formats and scan, copy and print any document. It even comes with a smart accounting feature that keeps track of billable services.

## 2 SOLUTION TYPES

Our two flexible MFP solution types make sure you'll find a setup that fits your situation exactly.

## MFP Solution: Just add a printer

A scanner/software/touch screen/stand solution that connects to any printer, saving you space, giving you access to more formats, and letting you share your scanner on the network. The bundle includes a scanner, Nextimage MFP software, touch screen, and high stand. Choose between the XD2490, SD3615, SD4420 (24", 36", 44") for technical drawings, blue prints and maps, or the HD Ultra Office 3630, with superb image quality even when scanning thick, fragile and folded documents.

## MFP Kit: Choose your scanner

A complete software/touch screen/stand solution for your choice of scanner. Gives you versatility, image quality, more scanning power, full-featured image enhancement control and an ultra-productive archival and copying/printing system. You get a Contex high stand, our Nextimage Repro software with full imaging capabilities, and a Contex touch screen. Compatible with XD2490, SD3600, SD4400 or HD Ultra scanners.

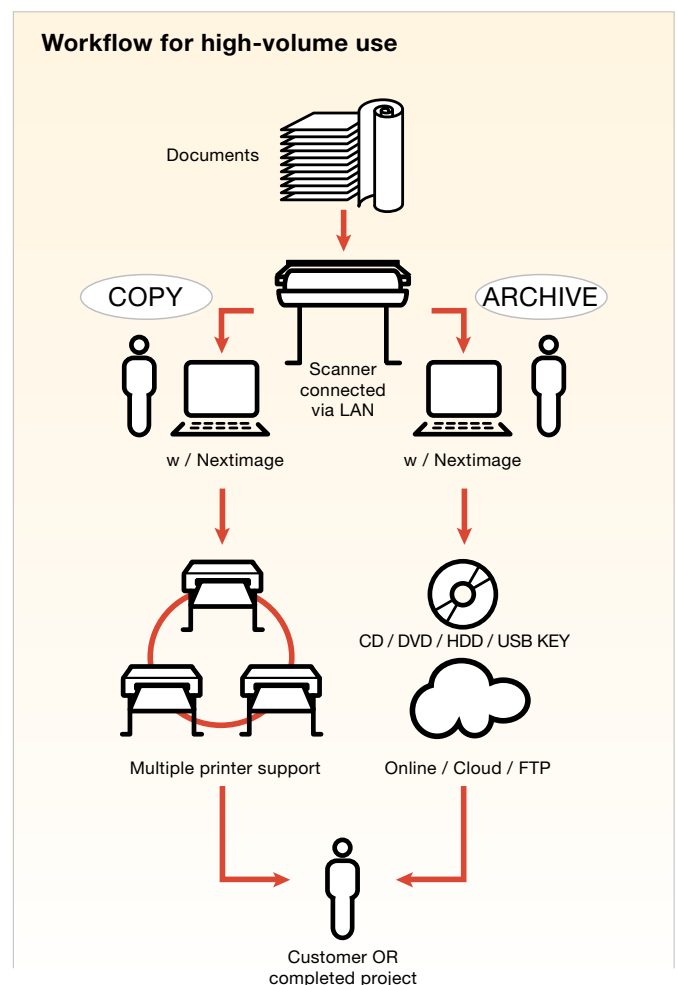

Workflow for office use

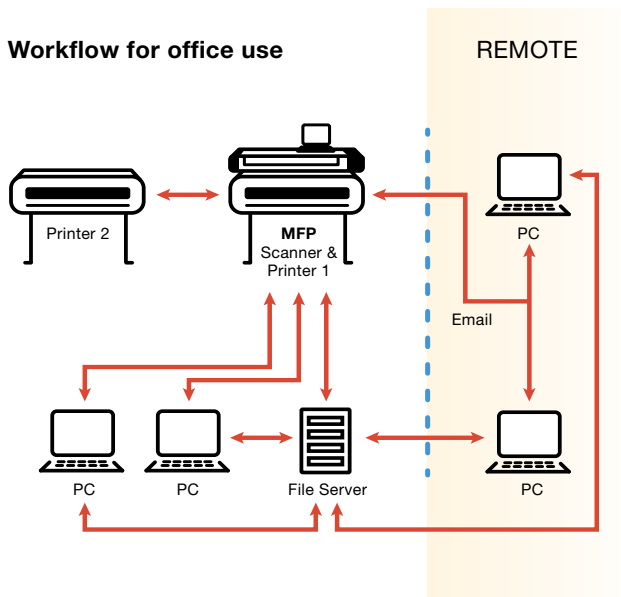

Contex Nextimage enhancement software

Nextimage MFP (comes with MFP Solution)	Nextimage Repro (comes with MFP Kit)
Touch-screen mode	Touch-screen mode
Basic Scan Functions	Full Scan Function
Batch scanning	Batch scanning
	Multi-page PDF, TIF files
	Job-accounting, scan-tracking
TIF, JPG, PDF file formats	TIF, JPG, PDF, DWF, CALS, BMP, JPEG-2000(JP2), JPEG2000 Extended(JPX), TIF-G3, TIF-G4, others
	Automatic file naming templates
	Customize/Edit index color palette
Basic Copy Functions	Full Copy Functions
Supports one printer	Supports unlimited printers
	Batch copy
Closed loop color calibration	Closed loop color calibration
	ICC color management
Basic Image Adjustments	Full Image Adjustment control
	Auto-rotate
	Auto-align / deskew
	Sharpen/Smoothen filter
Black/White level adjustment	Black/White level adjustment
	RGB level adjustments
	Histogram view
	Measurement tool



**XD2490 MFP**



**SD3615 MFP**



**SD4420 MFP**



**HD Ultra 3630 MFP**

Choose this affordable MFP solution as your daily tool for copying office graphics and documents. Perfect for small offices or businesses where traditional large-format copy solutions are too expensive or too large.

Get full color on-demand scanning, copying, emailing or printing in seconds. Easy plug-and-play operation and connectivity lets you do more with your existing equipment.

Leverage your existing printers and other office equipment with a 44" color scanner, intuitive touch screen, plug-and-play operation multi-function features that are easy to use and help everyone in your office work better together.

Copy, Scan, Print or Share any document - thick, curled, folded, fragile - in superb image quality and without compromising ease of use for any office worker. Features FlexFeed, SnapSize and more.

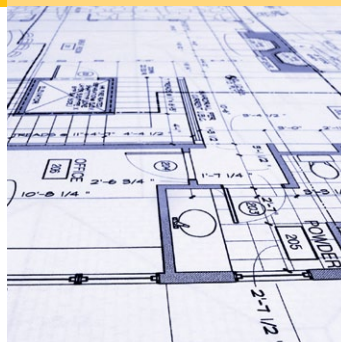
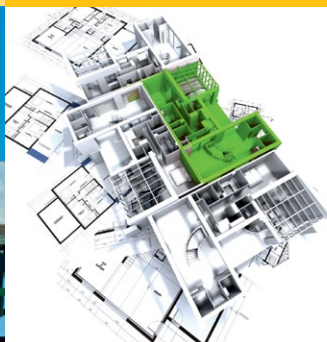

Devote more time to your projects and customers [www.contex.com](http://www.contex.com)

## About Contex

As the world's largest developer and producer of wide format imaging solutions, Contex leads the market with innovative technology and advanced scan and copy software solutions. Sold worldwide in over 80 countries, Contex solutions are recognized in a wide range of industries for reliability, value, high performance, and superb image quality.

As the global leader, we are always striving to deliver excellent service, superior products and great value to our partners and customers.

### Looking Ahead

Contex's research and development work and dedication to our customers have made us a leader in the large format scanning industry, and we will continue to devote ourselves to R&D and market growth in the years to come.

We are confident in our work and our ability to establish strong, enduring relationships with our customers and partners well into the future.

## Product range

### HDULTRASERIES



*– ultimate image quality*  
Boost productivity and get the ultimate in image quality. Encompassing the latest technologies, the versatile HD Ultra keeps your business running at full capacity.

### SDSERIES



*– your office workhorse*  
Scan, copy and share wide-format maps and drawings, with this reliable, easy-to-use office scanner.

### XD SERIES



*– affordable and portable*  
A durable, yet lightweight design makes the XD Series ideal for projects on the move, while still handling up to D or A1-sized documents.

### MFP SERIES



*– turn printers into copiers*  
Based on our HD Ultra, SD, or XD scanners, these space-saving, plug-and-play solutions come with touch-enabled screen and software for ease of use.

### NEXTIMAGE

You can copy, print, email, edit, and scan with Nextimage multi-function wide format software. Just one user-friendly interface, creating the perfect link between your scanner, digital storage, existing software, and printers.

### ISIS and TWAIN Drivers

The Contex ISIS driver lets you scan large format documents directly into your electronic document/content management workflow.

TWAIN lets you import images into your other software applications, including Adobe Photoshop, Microsoft Office, Autodesk and EDM solutions.

## Industries

We know that requirements vary depending on the types of documents you work with, so we've made sure you can find the right combination of speed, resolution and operational simplicity in our range of solutions, including scan-to-file, scan-to-print and multi-function capabilities. Contex solutions are ideal for processing CAD drawings, plans, blueprints, maps, posters, artwork and many other types of documents.

### Technical documents

- Government
- Architecture
- Engineering
- Construction
- Manufacturing
- Utilities

### GIS & mapping documents

- Civil Engineering
- Surveying
- Facility management
- Natural Resources
- Utilities
- Government

### Graphic documents

- Graphic Arts
- Photography
- Publishing
- Signs

### All document types

- Copy Shop
- Reprographics
- Printing and Document Services

### Other documents

No matter what it is – textile patterns, legal documents or other specialized media – our solutions handle them with care and create perfect reproductions.

## Locations

### EMEA & AP Branch Office

Contex A/S  
2 Svanevang  
DK-3450 Allerød  
Denmark  
Phone: +45 4814 1122  
Fax: +45 4814 0122  
emea-ap@contex.com

Contex Singapore Pte.Ltd.  
5004 Ang Mo Kio Ave. 5  
#04-03 TECHplace II  
Singapore 569872  
Phone: +65 68 538 135  
Fax: +65 64 815 428  
emea-ap@contex.com

### Americas Branch Office

Contex Americas Inc.  
365 Herndon Parkway, Suite 105  
Herndon, VA 20170  
USA  
Toll Free: +877-226-6839  
(877-2-CONTEX)  
Phone: +1 (703) 964 9850  
Fax: +1 (703) 547 3375  
SalesAmericas@contex.com

### China Branch Office

Contex A/S Shanghai  
30G, No. 1 Ruijin Road (S.)  
200023 Shanghai  
China  
Phone: +86 21 6422 2525  
Fax: +86 21 5496 0724  
info-china@contex.com

### Japan Branch Office

Contex  
Scanning Technology Japan A/S  
1-10-2F Nihonbashi Kabuto-Cho,  
Chuo-Ku 103-0026 Tokyo  
Japan  
Phone: +81 3 3669 5515  
Fax: +81 3 3669 5516  
info-japan@contex.com

### Head Office

Contex A/S  
2 Svanevang  
DK-3450 Allerød  
Denmark  
Phone: +45 4814 1122  
Fax: +45 4814 0122  
info@contex.com

[www.contex.com](http://www.contex.com)

